

APPROVAL STAMP

COLOUR NOTE

PLOT BOUNDARY SHOWN IN
 PROPOSED COMPOUND WALL SHOWN IN
 EXISTING SCHOOL BUILDING SHOWN IN
 DRAINAGE LINE SHOWN IN
 ROAD SHOWN IN

TITLE

PROPOSED LAY OUT AND COMPOUND
 PLAN OF EXISTING SCHOOL BUILDING
 ON CITY SURVEY. NO: 1021, AT : PAF
 TAL. : PARDI, DIST. : VALSAD.
 FOR : ASHADHAM SEVA MANDLc.

OWNER'S SIGNATURE

F. A. ...
 ASHADHAM SEVA MANDAL
 PAF, TAL. PARDI, DIST. VALSAD

ARCHITECT/ENGINEER

Pranami M.
 Arch-Tech Planner & Designers
 Pranami Street,
 Chhipwad, Valsad.

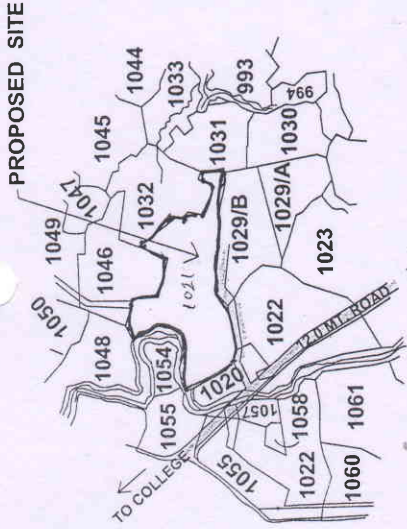

KEY PLAN
 SCALE: 1.0 CM. = 79.20 MT.

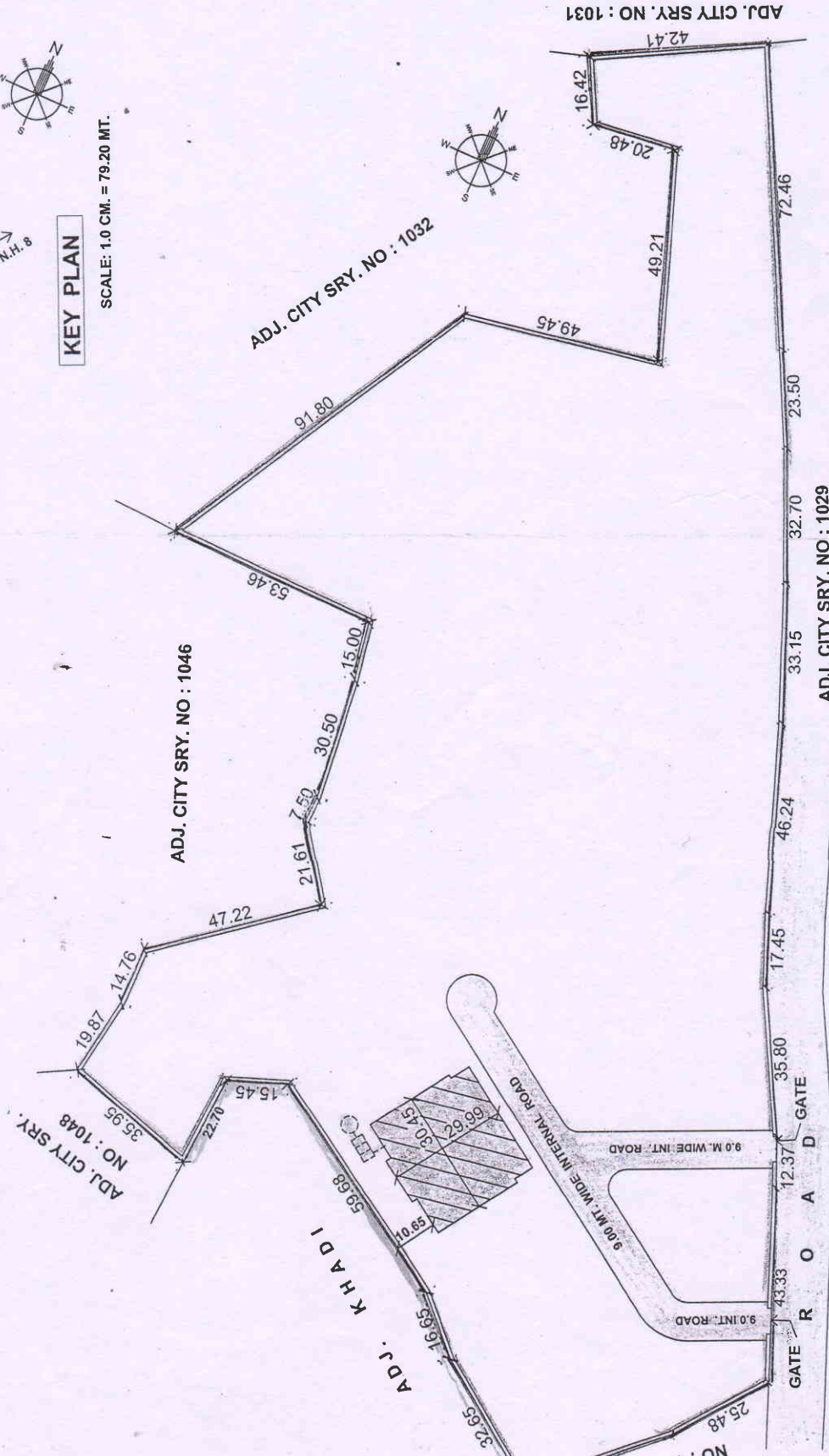
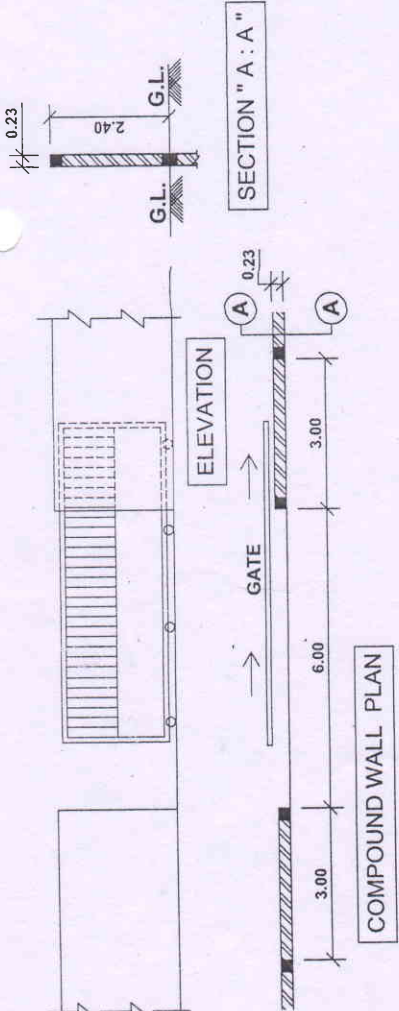

LAY OUT PLAN
 SCALE: 1: 1000